



Description

A three bedroom leasehold semi-detached house situated in the popular Broadfields area of Exeter. The property offers front and rear gardens backing on to Woodwater Academy, garage and on drive parking. Whilst in need of some updating the property offers tremendous potential as a family home or as a residential lettings investment.

Situated

Quarry Park Road is situated in the sought after Broadfields area of Exeter in proximity of both the Woodwater Academy and the Royal Devon and Exeter Hospital. Readily commutable to Exeter city centre, the M5/A30/A38 road networks and Exeter airport.

Ground Floor

Entrance hall, lounge/diner, kitchen.

First Floor

Landing, three bedrooms, wet room.

Outside

Front and rear gardens, garage and on drive parking.

Viewings

Strictly by prior appointment with Fulfords Exeter 01392 252666. General enquiries Countrywide Property Auctions 01395 275691.

Auctioneer’s Note

Please note that the property is currently suitable for cash buyers only.

EPC Rating

D



Council Tax Band C

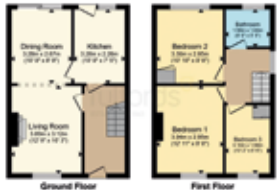

Not for use as a floor plan. It is a diagrammatic representation of the property. The actual layout may vary. The information is provided for general information only. It is not intended to be used as a basis for any legal proceedings.